



- MID TERRACE
- TWO BEDROOM
- GARDEN
- TWO ALLOCATED SPACES

This two bedroom mid terrace house is located within a short walk to Whiteley shops and restaurants and is available now. The property comprises of entrance hall, kitchen, lounge with patio doors leading to an enclosed rear garden. On the first floor there are two bedrooms and a family bathroom. The property also benefits two allocated

23 Angelica Way, Whiteley, Fareham, PO15 7HY

£825.00 pcm



[whiteandguard.com](http://whiteandguard.com)

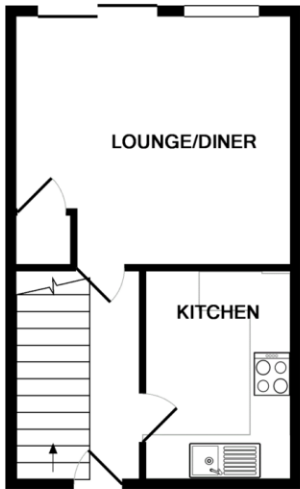

GROUND FLOOR  
APPROX. FLOOR  
AREA 270 SQ.FT.  
(25.1 SQ.M.)

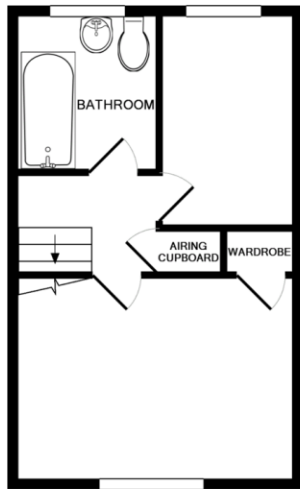

1ST FLOOR  
APPROX. FLOOR  
AREA 270 SQ.FT.  
(25.1 SQ.M.)

TOTAL APPROX. FLOOR AREA 540 SQ.FT. (50.2 SQ.M.)

Whilst every attempt has been made to ensure the accuracy of the floor plan contained here, measurements of doors, windows, rooms and any other items are approximate and no responsibility is taken for any error, omission, or mis-statement. This plan is for illustrative purposes only and should be used as such by any prospective purchaser. The services, systems and appliances shown have not been tested and no guarantee as to their operability or efficiency can be given  
Made with Metropix ©2018

%epcGraph\_c\_1\_349%

T: 01489 893946 Brook House, Brook Street, Bishops Waltham, Southampton, Hampshire, SO32 1AX

E: bishopsaltham@whiteandguard.com W: whiteandguard.com

PROPERTY MISDESCRIPTIONS ACT 1991 - Although every care has been taken in the production of these sales particulars prospective purchasers should note: 1. All measurements are approximate. 2. Services to the property, appliances, fixtures and fittings included in the sale are believed to be in working order (though they have not been checked). 3. Prospective purchasers are advised to arrange their own tests and-or surveys before proceeding with a purchase. 4. The agents have not checked the deeds to verify the boundaries. Intending purchasers should satisfy themselves via their solicitors as to the actual



Zoopla

rightmove

